

## Nylon anchor for hollow and solid material

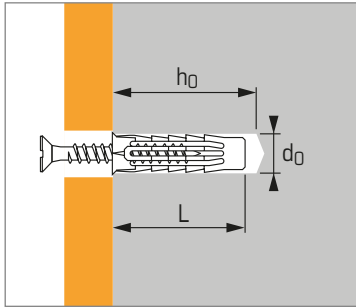

### APPLICATION

- Lightweight fixing in all base material
- Small electrical accessories, small light fittings, fuse boxes, etc...

### MATERIAL

- **Body:** polyamid 6  
Suitable temperature -20° + 40°C
- **\*Screw :** Special screw supplied, head type PZ2

### INSTALLATION

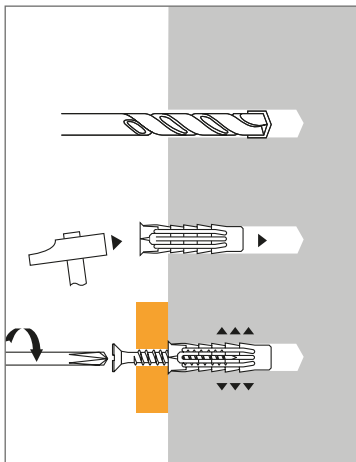

### Technical data

Anchor size	Screw diameter (mm)	Drilling depth (mm) <b>h<sub>0</sub></b>	Drilling diameter (mm) <b>d<sub>0</sub></b>	Total anchor length (mm) <b>L</b>	Code	
					without screw	with VBA screw*
5X25	3 - 4	35	5	25	565642	565646
6X30	4 - 5	40	6	30	565643	565647
8X40	4,5 - 6	50	8	40	565644	565648
10X50	6 - 8	65	10	50	565645	565649
12X60	8 - 10	75	12	60	565617	-
14X70	10 - 12	85	14	70	565618	-

### Recommended loads ( $N_{rec}$ ) and ultimate loads ( $N_{Ru,m}$ ) in kN with wood screw

#### TENSILE

Base material	Anchor size Screw Ø	Ø5	Ø6	Ø8	Ø10
		4	5	6	8
<b>Concrete (≥C20/25)</b>					
$N_{rec}^*$		0,28	0,28	0,50	0,70
$N_{Ru,m}^*$		1,40	1,40	2,50	3,50
<b>Hollow concrete blocks B 40</b>					
$N_{rec}^*$		0,23	0,3	0,43	0,46
$N_{Ru,m}^*$		1,15	1,5	2,15	2,30
<b>Clay bricks BP 400</b>					
$N_{rec}^*$		0,20	0,26	0,35	0,60
$N_{Ru,m}^*$		1,00	1,30	1,75	3,00
<b>Hollow clay bricks Eco 40</b>					
$N_{rec}^*$		0,17	0,19	0,23	0,25
$N_{Ru,m}^*$		0,85	0,95	1,15	1,25

\* Indicative values : depending on the type of screw used, the loads must be reduce by 50 %